

We will be using a variety of space throughout the Westin Peachtree Hotel for the entire conference:

6th Floor (All Tutorials, Student Lunch, All Workshops): International and Vinings Rooms

7th Floor (one Parallel Session) Augusta Rooms

8th Floor (Plenary and two Parallel Sessions): Peachtree Ballroom

10th Floor (one Parallel Session): Plaza Ballroom

73rd Floor (Welcome Reception): Sundial Complex

200 Building Grand Atrium (Poster/Demo/Dinner): Next door to the Westin, connected by a bridge room the Hotel

Tentative Room Schedule:

Registration on all days	8 th Level Terrace
Breakfast, Morning & Afternoon Breaks, and Exhibits on all Days	8th Level Terrace
Welcoming Reception, Sunday, June 9th	Sun Dial Complex, 73 rd Floor
IBM Sponsored Student Lunch	Vinings, 6 th Floor
Poster, Demo, Dinner Session, Monday Evening, June 10th	200 Building Grand Atrium, connected by bridge from the Westin
Banquet, Tuesday Evening, June 11th	World of Coca-Cola Museum

Morning Tutorials, Sunday, June 9th:	
Tutorial 1: Deep Learning for NLP (without Magic)	International B,C
Tutorial 2: Discourse Processing	International D
Tutorial 3: Towards Reliability-Aware Entity Analytics and Integration for Noisy Text at Scale	International E,F
Afternoon Tutorials, Sunday, June 9th:	
Tutorial 4: Semantic Role Labeling	International G,H
Tutorial 5: Spectral Learning Algorithms for Natural Language Processing	International B,C
Tutorial 6: Morphological, Syntactical and Semantic Knowledge in Statistical Machine Translation	International D

Main Conference Sessions, Monday–Wednesday, June 10th–June 13th	
All Plenary Sessions	Peachtree Ballroom
Parallel Session- Track I	Peachtree B,C
Parallel Session - Track 2	Peachtree D,E
Parallel Session - Track 3	Plaza Ballroom
Parallel Session - Track 4	Augusta

Workshops, Thursday, June 13th	
*SEM (Plenary and Parallel)	International D
*SEM (Parallel) SemEval	International E
*SEM Poster Sessions	The Overlook
Workshop 1: Speech and Multimodal Interaction in Assistive Environments (SMIAE 2013) CANCELLED	International F
Workshop 2: The 8th Workshop on Innovative Use of NLP for Building Educational Applications (BEA)	International G
Workshop 3: Seventh Workshop on Syntax, Semantics and Structure in Statistical Translation (SSST-7)	International B
Workshop 4: First Workshop on Metaphor in NLP	International A
Workshop 5: Ninth Workshop on Multiword Expressions (MWE 2013) (day 1)	International C
Workshop 6: Language Analysis in Social Media 2013	International H

Workshops, Friday, June 14th	
*SEM (Parallel) SemEval	International E
*SEM Poster Sessions	The Overlook
Workshop 5: Ninth Workshop on Multiword Expressions (MWE 2013) (cont'd. half day)	International C
Workshop 7: Events: Definition, Detection, Coreference, and Representation	International B
Workshop 8: Workshop on Vision and Natural Language Processing	International H
Workshop 9: Computational Linguistics for Literature	International G
Workshop 10: Natural Language Processing for Improving Textual Accessibility (NLP4ITA)	International F
Workshop 11: 4th Workshop on Computational Approaches to Subjectivity, Sentiment and Social Media Analysis (WASSA 2013)	International A

SemEval and Joint NAACL/ICML Symposium, Saturday, June 15th	
*SEM (SemEval, continued)	International E
Joint NAACL/ICML Symposium	TBA

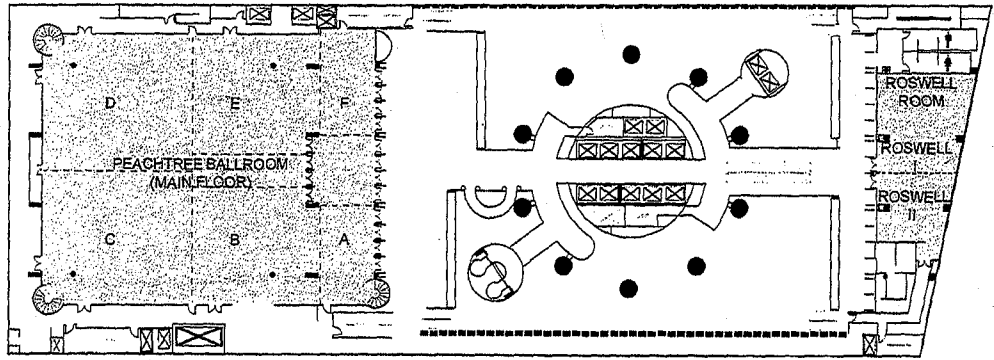

EIGHTH FLOOR

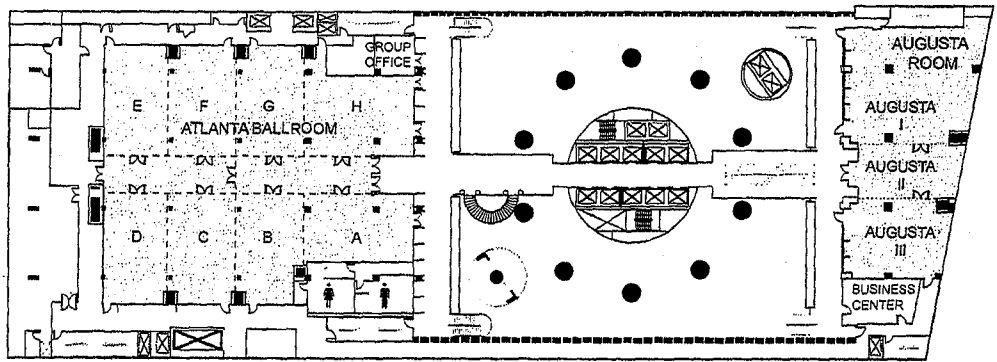

SEVENTH FLOOR

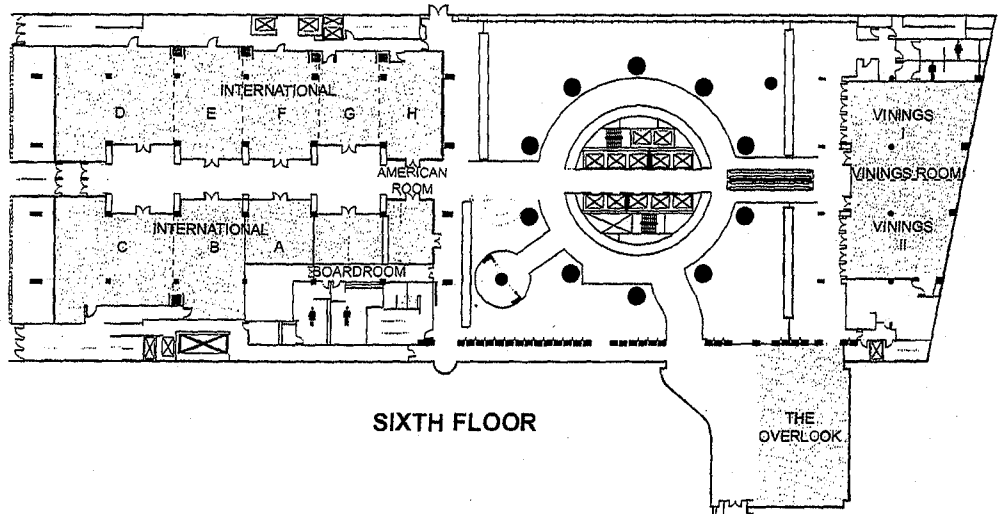

SIXTH FLOOR

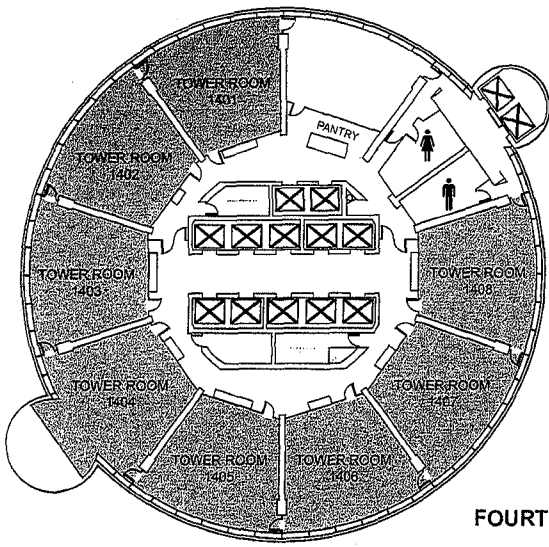

FOURTEENTH FLOOR

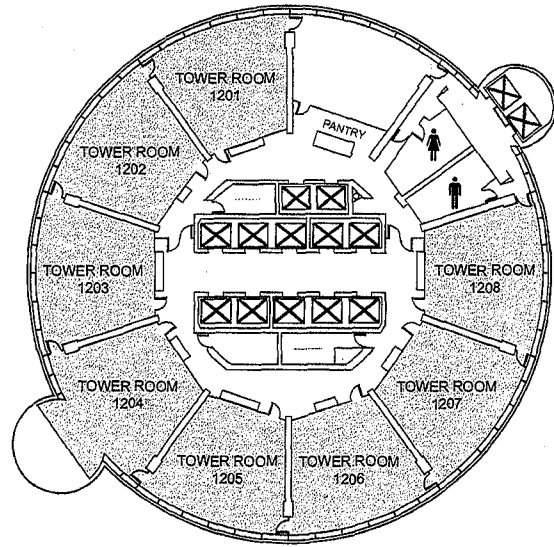

TWELFTH FLOOR

TENTH FLOOR

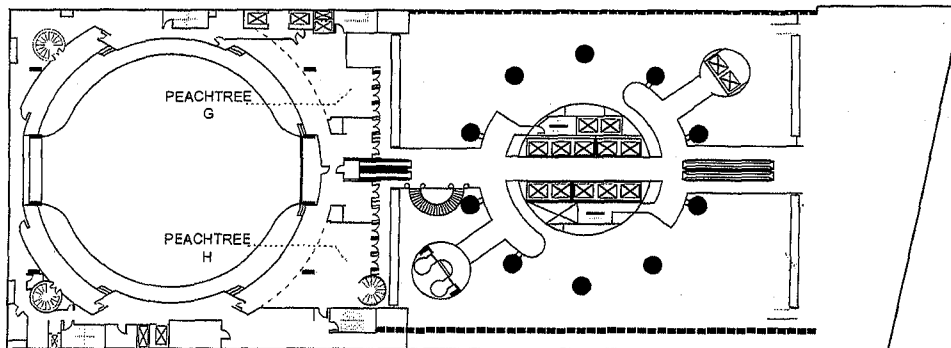
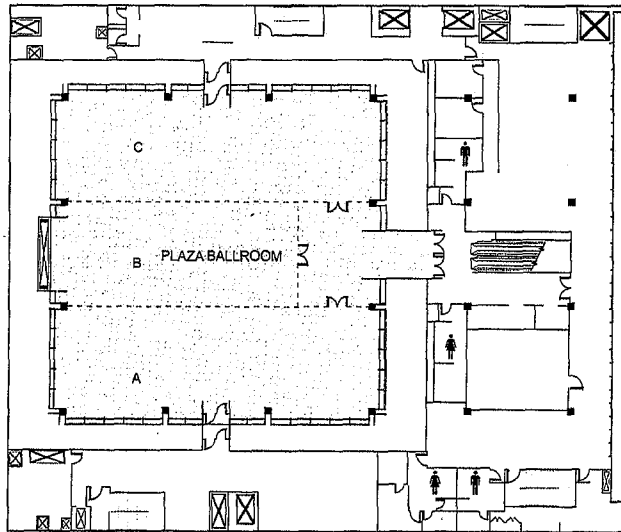

NINTH FLOOR